



**Safe passive storage of lithium-ion batteries**

**Function / construction:**

- **Robust construction and longevity:** triple hinged door, safety elements assembled outside the storage compartment for increased protection against corrosion, scratch- and impact-resistant surface, easy to clean
- **Easy handling with comfort:** smooth door with permanent self-closing function and oil-dampened door closer; open door with a minimum amount of force
- **No unauthorised use:** door lockable with cylinder locking (integration in an existing locking system possible) and locking state indicator (red/green)

- **Easy transport:** integrated transport base for internal transportation
- **Easy alignment:** adjusting aids to compensate for uneven floor
- **All-around protection:** 90 minute fire protection from outside to inside (type 90 / type tested in accordance with EN 14470-1) and for more than 90 minutes fire resistance for fires from inside to outside

**Available equipment:**

- Bottom collecting sump
- Perforated shelves with load capacity of 25 kg

**BATTERY STORE storage cabinet**  
**ION-STORE-90 model IO90.195.060.K1.WDC**  
 body colour anthracite grey (RAL 7016), with wing door in gentian blue (RAL 5010), interior equipment with 3 x perforated shelf, 1 x bottom collecting sump (sheet steel powder-coated)  
**Order No. 38067-047-38086**



**EXPERT TIP**

Lithium-ion batteries with **obvious damage** should generally **not be stored inside buildings.**

Dispose of them **promptly in appropriate disposal containers** suitable for transportation, **outside of buildings.**

**Are you looking for an appropriate storage solution for hazardous materials?**

Our optimised online product configurator helps you, step by step, to find the suitable safety storage cabinet.

Take the test:  
[www.asecos-configurator.com](http://www.asecos-configurator.com)

**Maximum flexibility**  
 No problem with the ION-LINE including transport base for in-house transport

**Bottom collecting sump**  
 The bottom collecting sump is used to catch any leakage which may occur from burning batteries.

**Perforated shelves as storage / charging levels**  
 Made of sheet steel powder-coated offer a high storage capacity and ensure optimal ventilation inside the cabinet to avoid heat build-up during charging.

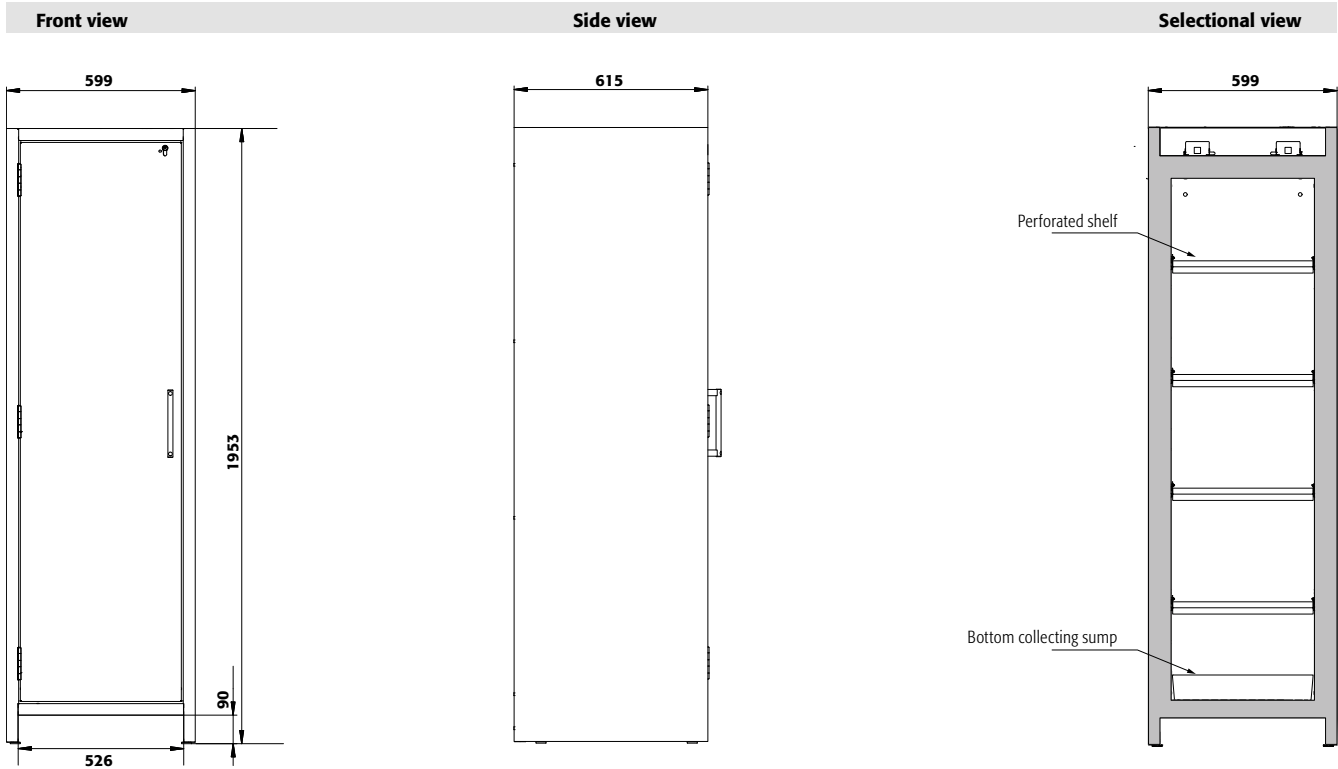

**Technical data**

**IO90.195.060.K1.WDC**

External dimensions W x D x H	mm	599 x 615 x 1953
Internal dimensions W x D x H	mm	450 x 522 x 1647
Weight without interior equip.	kg	265
Maximum load	kg	600
Distributed load	kg/m <sup>2</sup>	894
Entry width transport base	mm	526
Entry height transport base	mm	90

**Top view**

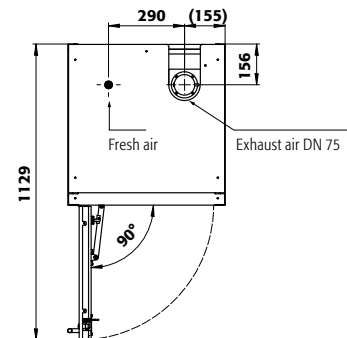

**Order example - how to order correctly**



	<b>Model</b>	<b>Information / equipment</b>	<b>Order No.</b>
	IO90.195.060.K1.WDC	without interior equipment, left hinged	38067
	<b>Body colour</b>	<b>Door colour</b>	<b>Order No.</b>
	Anthracite grey RAL 7016	gentian blue RAL 5010	047 4
	<b>Interior equipment packages</b> (can only be ordered in combination with the cabinet)	<b>Material</b>	<b>Order No.</b>
	3x perforated shelf, 1x bottom collecting sump (V=11.5L)	sheet steel powder-coated RAL 7035	38086 2
	4x perforated shelf, 1x bottom collecting sump (V=11.5L)	sheet steel powder-coated RAL 7035	38087 2
	5x perforated shelf, 1x bottom collecting sump (V=11.5L)	sheet steel powder-coated RAL 7035	38088 2
	6x perforated shelf, 1x bottom collecting sump (V=11.5L)	sheet steel powder-coated RAL 7035	38089 2
	<b>Interior equipment</b>	<b>Material</b>	<b>W x D x H (mm)</b>
	Perforated shelf	sheet steel powder-coated RAL 7035	440 x 437 x 40*
	Document holder DIN A5	polystyrene	

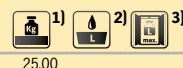

\* usable storage space W x D (mm)  
1) load capacity [kg], 2) retention capacity [ltr], 3) maximum container volume in the cabinet [ltr]